

FOR LEASE

6565 Davis Industrial Parkway

Solon, Ohio 44139



3,600 SF - 16,794 SF OFFICE/WAREHOUSE SPACE

PROPERTY FEATURES



90,146 SF

BUILDING SIZE

8.13 ACRES

SITE SIZE

\$8.50/SF NNN

LEASE RATE

PROPERTY SPECIFICATIONS

CONSTRUCTED:	1998
CONSTRUCTION:	Masonry
ROOF:	Shingle
HEAT:	Rooftop HVAC
A/C:	HVAC - Office
LIGHTING:	LED
SPRINKLER:	Yes
CLEAR HEIGHT:	Office - 10', Warehouse - 18'
DRIVE-IN DOORS:	Four (4)
DOCKS:	Ten (10) - 8'x8'8"
POWER:	480A/270V/3P

COMMENTS

- Excellent Class A flex space available
- 18' clear heights for warehouse space and 10' ceiling heights for office space
- New roof in 2024
- Located near the Uptown Solon shopping including high end restaurants and big box retailers
- Four (4) drive-in bays and 10 exterior dock doors provide ample opportunities for different tenants

CURRENT AVAILABILITY

SUITE	TOTAL SF	OFFICE SF	WHSE SF	DOCKS	DRIVE-IN
A	16,792 SF	15,000 SF	1,792 SF	1	1
L	7,659 SF	5,252 SF	2,407 SF	1	-0-
N	3,600 SF	3,600 SF	-0-	1	-0-

SITE PLAN

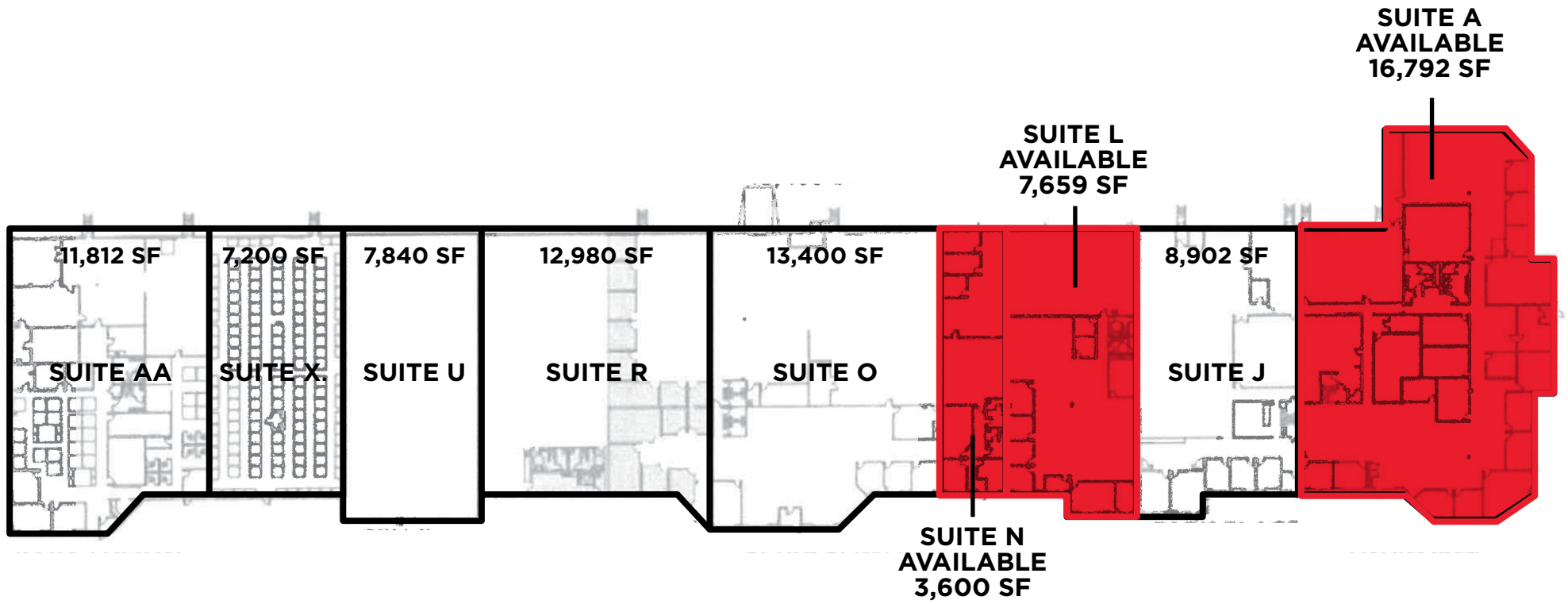

SUITE A PHOTOS



SUITE L PHOTOS

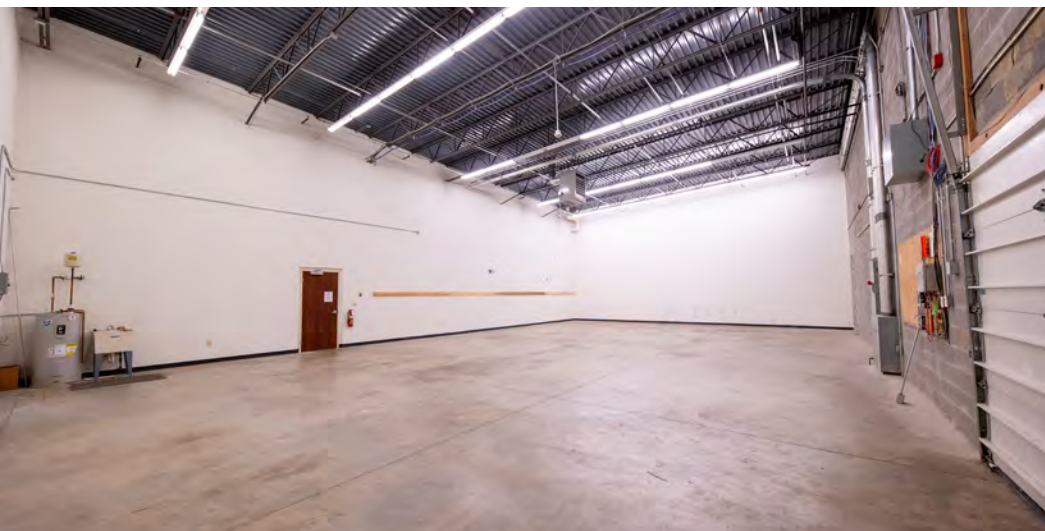

SUITE N PHOTOS



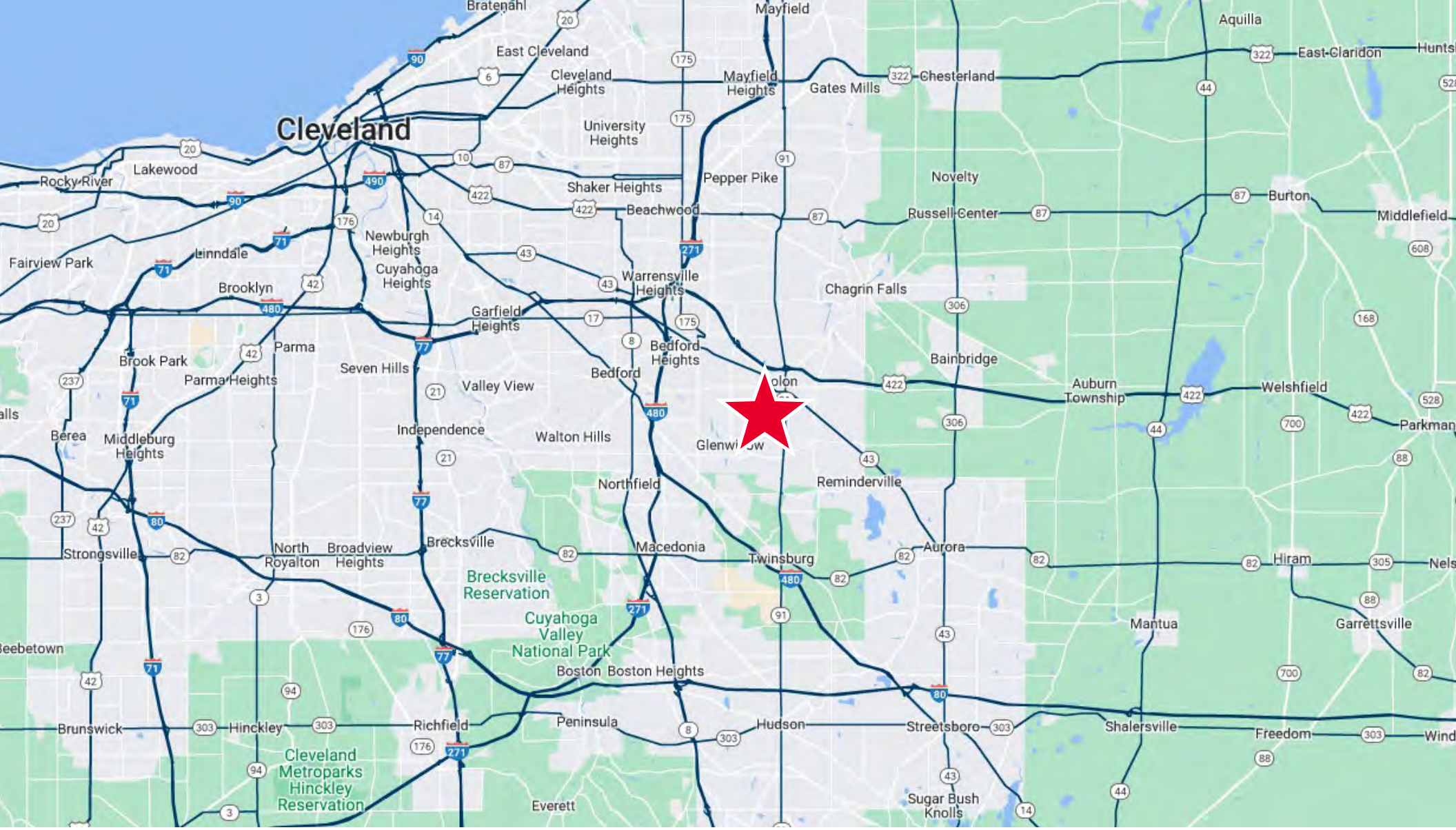

Easy access
to I-480 & I-271



ELIOT KIJEWski, SIOR

Principal
+1 216 525 1487
ekijewski@crescorealestate.com

SIMON CAPLAN, SIOR

Executive Vice President & Partner Emeritus
+1 216 525 1472
scaplan@crescorealestate.com

Independently Owned and Operated / A Member of the Cushman & Wakefield Alliance

Cushman & Wakefield Copyright 2023. No warranty or representation, express or implied, is made to the accuracy or completeness of the information contained herein, and same is submitted subject to errors, omissions, change of price, rental or other conditions, withdrawal without notice, and to any special listing conditions imposed by the property owner(s). As applicable, we make no representation as to the condition of the property (or properties) in question. A licensee at Cushman & Wakefield | CRESCO may have an interest in the client entity offering this property for sale.

6100 Rockside Woods Blvd. N., Suite 200
Cleveland, Ohio 44131
Main +1 216 520 1200
crescorealestate.com